

# SINC Recording Form

## SITE SUMMARY

SITE NAME:

GRID REF:  SURVEYOR(S):

SIZE (approx.): 4.95ha  
 DATE OF SURVEY:

LOCAL AUTHORITY AREA:  SOIL TYPE:   
 GEOLOGY:

WARD:  SLOPE:  HEIGHT IN M:

### MAIN HABITAT TYPES PRESENT:

Habitat types	NVC type	Area (ha)
Species-rich grassland	MG5	1
Amenity grassland		1
Scrub		>0.5
Coastal grassland and cliffs		>0.5

### SKETCH MAP OF SITES LOCATION:

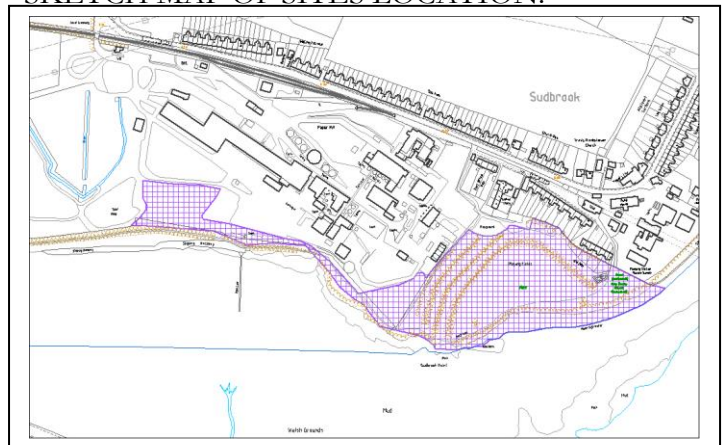

### LBAP PRIORITY HABITATS/SPECIES PRESENT?

### FULL DESCRIPTION OF SITE (including topography, adjacent land use, boundaries etc.):

This site lies to the south and south-east of the former Paper Mill in Sudbrook and includes embankments of a former fort (Scheduled Ancient Monument) with species rich grassland, tall herb, scrub and coastal grassland and vegetated slopes. Also located within the middle of this area is amenity grassland managed as a sports field. Coastal habitats skirt the south of the site and include an ephemeral water body. The site is on the edge of the Severn Estuary including the designated SPA/SAC/RAMSAR site. The site boundaries are formed by coastal fringe habitats extending east, south and west, with the paper mill and village of Sudbrook bordering the site to the north.

The most diverse unimproved species-rich grassland are limited to the west corner of the Schedule Ancient Monument site and include abundant yellow oat grass, rough meadow grass, glaucous sedge, rock-rose, common bird's-foot trefoil, ladies bedstraw, and frequent salad burnet, common restharrow, yarrow, common knapweed, crested dog's tail, and occasional pignut, wild carrot, burnet saxifrage, wild onion and hoary plantain.

Away from this area on the embankments and in the east of the Schedule Ancient Monument, species-rich grasslands are also found but these tend towards a coarser less diverse sward and in places have more of a coastal influence such as the occurrence of locally dominant sea couch. Stands of rosebay willowherb, other tall ruderal species and scrub in-part dominate much of the site away from the sports pitch. There is evidence of some burning the south facing embankment towards the north of the site.

An ephemeral water body (wet during first survey and dry during second) also exists at the western end of the SINC and considered important enough to include in the site boundary by the SINC expert panel. Water-plantain was frequent in 2010.

The grassland, water body, scrub and tall ruderal areas are likely to support a variety of invertebrates and it is possible that shrill carder bee maybe be present owing to the close proximity of the Gwent Levels population although this species wasn't searched for during the survey.

**Official Use Only:** Site selected as a Wildlife Site/SINC? YES  NO  Date: 15/07/2010

# DETAILED SITE INFORMATION

SITE OWNERSHIP: Including names of any tenants/graziers

Name(s)		
Address		
Tel.no.		Mobile: <input type="text"/>

Please log all landowner/tenant contact starting from the initial permission for access to survey

Date	Contact	Discussion subjects/decisions made

Is/are the owner(s)

i) aware of the site's nature conservation value?	Yes <input type="checkbox"/>	No <input type="checkbox"/>	
ii) managing the land sympathetically?	Yes <input type="checkbox"/>	No <input type="checkbox"/>	
iii) willing to manage the land sympathetically?	Yes <input type="checkbox"/>	No <input type="checkbox"/>	Unknown <input type="checkbox"/>

Describe the access to the site:

Via Camp Road either along a footpath at the east end or the road at the west end.

Are there any public rights of way on the site? **Yes**

If so please describe their location:

Scheduled Ancient Monument part only. A footpath enters the site at the east corner then continues along the southern edge of the site before continuing beyond the west site boundary.

What is the current management at the site?

Short grass is mown on the sports pitch towards the centre of the site, there was no evidence of other management elsewhere on site.

Are there any threats to the site?

Development, LDP candidate site CS/0260  
Fire  
Lack of habitat management

Are there any invasive species present?

Are there any protected species present?

Please state the section(s) of the Wildlife Site Guidelines that this site qualifies under:

H20 Mosaic habitats with H5 calcareous grassland as the main qualifying habitat supported by coastal habitats, scrub and water feature.

Is the site part of any grant schemes? Yes  No  Grant Scheme:.....End date:.....

Does the site already have any designations? Yes  No  Designation:.....

Phase one map of site:



Please list all additional survey information both past and present that relates to this site:

LDP ecological assessment 2009 ref: CS/0260

---

**OFFICE USE ONLY**

Site no.:

Please note: The data on this form may be held in accordance with the Monmouthshire County Council's registration under the Data Protection Act 1996

---

SITE NAME:

FIELD NUMBER:

South west bank species-rich grassland

	<input type="checkbox"/>	D		<input type="checkbox"/>	D		<input type="checkbox"/>	D
Agrostis tenuis (common bent)	✓	a	Conopodium majus (pignut)	✓	o	Primula veris (cowslip)		
Agrostis stolonifera (creeping bent)			Crepis capillaris (smooth hawks-beard)			Prunella vulgaris (self-heal)		
Aira praecox (early hair-grass)			Crepis biennis (rough hawks-beard)			Pteridium aquilinum (bracken)		
Alopecurus geniculatus (marsh foxtail)			Dactylorhiza fuchsii (c. spotted orchid)			Pulicaria dysenterica (fleabane)		
Alopecurus pratensis (meadow foxtail)			Dactylorhiza praetermissa (s.msh orchid)			Ranunculus acris (meadow buttercup)		
Anthoxanthum odoratum (sweet vnl grass)	✓	o	Daucus carota (wild carrot)	✓	o	Ranunculus auricomus (gldlcks buttercup)		
Arrhenatherum elatius (false oat grass)	✓	f	Equisetum arvense (field horsetail)			Ranunculus bulbosus (bulbous buttercup)		
Brachypodium pinnatum (tor grass)			Erica cinerea (bell-heather)			Ranunculus flammula (lesser spearwort)		
Briza media (quaking grass)			Erica tetralix (cross-leaved heath)			Ranunculus repens (creeping buttercup)		
Bromopsis erecta (upright brome)			Eupatorium cannabinum (hemp-agrimony)			Rhinanthus minor (yellow rattle)		
Bromus commutatus (meadow brome)			Euphorbia amygdaloides (wood spurge)			Rubus fruticosus (bramble)	✓	o/ld
Bromus racemosus (smooth brome)			Euphrasia officinalis agg. (eyebright)			Rumex acetosa (common sorrel)		
Cynosurus cristatus (crested dog's tail)	✓	f	Filipendula ulmaria (meadowsweet)			Rumex acetosella (sheeps sorrel)		
Dactylis glomerata (cocks foot)	✓	a	Fragaria vesca (wild strawberry)			Sanguisorba minor (salad burnet)	✓	f
Danthonia decumbens (heath grass)			Galium odoratum (sweet woodruff)			Scabiosa columbaria (small scabious)		
Deschampsia caespitosa (ftfd hair grass)			Galium palustre (marsh-bedstraw)			Scrophularia nodosa (figwort)		
Deschampsia flexuosa (wavy hair-grass)			Galium saxatile (heath bedstraw)			Senecio aquaticus (marsh ragwort)		
Eriophorum angustifolium (cmn cttngress)			Galium verum (lady's bedstraw)	✓	a	Senecio jacobea (ragwort)		
Festuca ovina (sheep's fescue)			Genista tinctoria (dyers greenweed)			Silaum silaus (pepper-saxifrage)		
Festuca rubra (red fescue)	✓	a	Geranium pratense (meadow cranes bill)			Stachys officinalis (betony)		
Glyceria fluitans (floating sweet-grass)			Geranium robertianum (herb robert)			Stachys palustris (marsh woundwort)		
Helictotrichon pratense (mdw oat-grass)			Glechoma hederacea (ground ivy)			Stachys sylvatica (hedge woundwort)		
Holcus lunatus (yorkshire fog)			Helianthemum nummularium (rock-rose)	✓	f/la	Stellaria graminea (lesser stichwort)		
Holcus mollis (creeping soft grass)	✓	o	Heracleum sphondylium (hogweed)			Stellaria holostea (greater stichwort)		
Lolium perenne (perennial rye grass)	✓	o	Hyacinthoides non-scripta (bluebell)			Succisa pratensis (devils bit-scabious)		
Milium effusum (wood millet)			Hypericum maculatum (imp St Johns-Wort)			Taraxacum officinale (dandelion)		
Melica uniflora (wood mellick)			Hypericum perforatum (pf St Johns-Wort)			Thymus polytrichus (wild thyme)		
Molinia caerulea (purple moor-grass)			Hypericum tetrapterum (sq.sd StJns-Wort)			Trifolium medium (zig zag clover)		
Nardus stricta (mat grass)			Hypochoeris glabra (smooth cats ear)			Trifolium pratense (red clover)	✓	f
Phalaris arundinacea (reed canary grass)			Hypochoeris radicata (common cats ear)			Trifolium repens (white clover)		
Phleum pratense (timothy grass)			Jasione montana (sheep's bit)			Tragopogon pratensis (goat's-beard)		
Poa annua (annual meadow grass)			Juncus acutiflorus (sharp-flowered rush)			Vaccinium myrtillus (bilberry)		
Poa trivialis (rough meadow grass)	✓	a	Juncus articulatus (jointed rush)			Valeriana dioica (marsh valerian)		
Trisetum flavescens (yellow oat grass)	✓	a	Juncus conglomeratus (compact rush)			Valeriana officinalis (common valerian)		
Achillea millefolium (yarrow)	✓	f	Juncus effusus (soft rush)			Veronica beccabunga (brooklime)		
Achillea ptarmica (sneezewort)			Juncus inflexus (hard rush)			Veronica chamaedrys (gemdr. speedwell)		
Agrimonia eupatoria (agrimony)	✓	o	Juncus squarrosus (heath rush)			Vicia cracca (tufted vetch)		
Ajuga reptans (bugle)			Juncus subnodulosus (blunt-flowerd rush)			Vicia sativa (common vetch)		
Alchemilla filicaulis (Lady's mantle)			Knautia arvensis (field scabious)	✓	f	Vicia sepium (bush vetch)		
Alliaria petiolata (garlic mustard)			Lamium album (yellow archangel)			Viola canina (heath dog-violet)		
Allium ursinum (ramsons)			Lathyrus nissolia (grass vetchling)			Viola reichenbachiana (pale dog-violet)		
Anemone nemorosa (wood anemone)			Lathyrus pratensis (meadow vetchling)			Viola riviniana (common dog violet)		
Angelica sylvestris (wild angelica)			Leontodon autumnalis (autumn hawkbit)			Wahlenbergia hederacea (ivy-lvd bl-flower)		
Blackstonia perfoliata (yellow-wort)			Leontodon hispidus (rough hawkbit)			Allium vineale	✓	o
Calluna vulgaris (ling heather)			Leontodon saxatilis (lesser hawkbit)			Plantago media	✓	o
Caltha palustris (marsh marigold)			Leucanthemum vulgare (oxeye daisy)					
Campanula rotundiflora (harebell)			Linum catharticum (fairly flax)					
Campanula trachelium (net-lvd bellflower)			Listera ovata (tway-blade orchid)					
Cardamine pratensis (cuckoo flower)			Lotus corniculatus (birds-foot trefoil)	✓	a			
Carex caryophylla (spring sedge)			Lotus uliginosus (greater birds-foot trefoil)					
Carex disticha (brown sedge)			Luzula campestris (field wood rush)					
Carex divulsa (grey sedge)			Luzula multiflora (heath wood-rush)					
Carex echinata (star sedge)			Lychnis flos-cuculi (ragged robin)					
Carex flacca (glaucous sedge)	✓	a	Melampyrum pratense (cow-wheat)					
Carex nigra (common sedge)			Mentha aquatica (water mint)					
Carex ovalis (oval sedge)			Mercurialis perennis (dog's-mercury)					
Carex panicea (carnation sedge)			Myosotis arvensis (field forget-me-not)					
Carex pendula (pendulous sedge)			Narcissus pseudonarcissus (wild daffodill)					
Carex remota (distant sedge)			Oenanthe crocata (hmlck water-dropwort)					
Carex riparia (greater pond-sedge)			Ononis repens (common restharrow)	✓	f			
Carex rostrata (bottle sedge)			Ophrys apifera (bee orchid)			Fauna recorded during survey:		
Carex spicata (spiked sedge)			Orchis mascula (early purple orchid)					
Carex sylvatica (wood sedge)			Orchis morio (green-winged orchid)					
Centaurea nigra (common knapweed)	✓	f	Pilosella officinarum (mse-ear hawkweed)					
Centaurea scabiosa (greater knapweed)			Pimpinella saxifraga (burnet saxifrage)	✓	o			
Centaureum erythraea (cmmn century)			Plantago lanceolata (ribwort plantain)					

SITE NAME:

FIELD NUMBER:

semi-improved grassland

	<input type="checkbox"/>	D		<input type="checkbox"/>	D		<input type="checkbox"/>	D
Agrostis tenuis (common bent)	✓	f	Conopodium majus (pignut)			Primula veris (cowslip)		
Agrostis stolonifera (creeping bent)			Crepis capillaris (smooth hawks-beard)			Prunella vulgaris (self-heal)		
Aira praecox (early hair-grass)			Crepis biennis (rough hawks-beard)			Pteridium aquilinum (bracken)		
Alopecurus geniculatus (marsh foxtail)			Dactylorhiza fuchsii (c. spotted orchid)			Pulicaria dysenterica (fleabane)		
Alopecurus pratensis (meadow foxtail)			Dactylorhiza praetermissa (s.msh orchid)			Ranunculus acris (meadow buttercup)		
Anthoxanthum odoratum (sweet vnl grass)	✓	f	Daucus carota (wild carrot)	✓	o	Ranunculus auricomus (gldlecks buttercup)		
Arrhenatherum elatius (false oat grass)	✓	a	Equisetum arvense (field horsetail)			Ranunculus bulbosus (bulbous buttercup)		
Brachypodium pinnatum (tor grass)			Erica cinerea (bell-heather)			Ranunculus flammula (lesser spearwort)		
Briza media (quaking grass)			Erica tetralix (cross-leaved heath)			Ranunculus repens (creeping buttercup)		
Bromopsis erecta (upright brome)			Eupatorium cannabinum (hemp-agrimony)			Rhinanthus minor (yellow rattle)		
Bromus commutatus (meadow brome)			Euphorbia amygdaloides (wood spurge)			Rubus fruticosus (bramble)	✓	o/la
Bromus racemosus (smooth brome)			Euphrasia officinalis agg. (eyebright)			Rumex acetosa (common sorrel)		
Cynosurus cristatus (crested dog's tail)			Filipendula ulmaria (meadowsweet)			Rumex acetosella (sheeps sorrel)	✓	o/la
Dactylis glomerata (cocks foot)	✓	a	Fragaria vesca (wild strawberry)			Sanguisorba minor (salad burnet)		
Danthonia decumbens (heath grass)			Galium odoratum (sweet woodruff)			Scabiosa columbaria (small scabious)		
Deschampsia caespitosa (tfd hair grass)			Galium palustre (marsh-bedstraw)			Scrophularia nodosa (figwort)		
Deschampsia flexuosa (wavy hair-grass)			Galium saxatile (heath bedstraw)			Senecio aquaticus (marsh ragwort)		
Eriophorum angustifolium (cmn ctgrass)			Galium verum (lady's bedstraw)	✓	f	Senecio jacobea (ragwort)		
Festuca ovina (sheep's fescue)			Genista tinctoria (dyers greenweed)			Silaum silaus (pepper-saxifrage)		
Festuca rubra (red fescue)	✓	a	Geranium pratense (meadow cranes bill)			Stachys officinalis (betony)		
Glyceria fluitans (floating sweet-grass)			Geranium robertianum (herb robert)			Stachys palustris (marsh woundwort)		
Helictotrichon pratense (mdw oat-grass)			Glechoma hederacea (ground ivy)			Stachys sylvatica (hedge woundwort)		
Holcus lunatus (yorkshire fog)	✓	f	Helianthemum nummularium (rock-rose)			Stellaria graminea (lesser stichwort)	✓	f
Holcus mollis (creeping soft grass)			Heracleum sphondylium (hogweed)	✓	o	Stellaria holostea (greater stichwort)		
Lolium perenne (perennial rye grass)	✓	o	Hyacinthoides non-scripta (bluebell)			Succisa pratensis (devils bit-scabious)		
Milium effusum (wood millet)			Hypericum maculatum (imp St Johns-Wort)			Taraxacum officinale (dandelion)		
Melica uniflora (wood mellick)			Hypericum perforatum (pf St Johns-Wort)	✓	o	Thymus polytrichus (wild thyme)		
Molinia caerulea (purple moor-grass)			Hypericum tetrapetrum (sq.sd StJns-Wort)			Trifolium medium (zig zag clover)		
Nardus stricta (mat grass)			Hypochoeris glabra (smooth cats ear)			Trifolium pratense (red clover)	✓	o/la
Phalaris arundinacea (reed canary grass)			Hypochoeris radicata (common cats ear)	✓	f	Trifolium repens (white clover)		
Pheum pratense (timothy grass)			Jasione montana (sheep's bit)			Tragopogon pratensis (goat's-beard)		
Poa annua (annual meadow grass)			Juncus acutiflorus (sharp-flowered rush)			Vaccinium myrtillus (bilberry)		
Poa trivialis (rough meadow grass)	✓	f	Juncus articulatus (jointed rush)			Valeriana dioica (marsh valerian)		
Trisetum flavescens (yellow oat grass)	✓	a	Juncus conglomeratus (compact rush)			Valeriana officinalis (common valerian)		
Achillea millefolium (yarrow)	✓	f	Juncus effusus (soft rush)			Veronica beccabunga (brooklime)		
Achillea ptarmica (sneezewort)			Juncus inflexus (hard rush)			Veronica chamaedrys (gemdr. speedwell)		
Agrimonia eupatoria (agrimony)	✓	o	Juncus squarrosus (heath rush)			Vicia cracca (tufted vetch)		
Ajuga reptans (bugle)			Juncus subnodulosus (blunt-flowerd rush)			Vicia sativa (common vetch)	✓	f
Alchemilla filicaulis (Lady's mantle)			Knautia arvensis (field scabious)			Vicia sepium (bush vetch)		
Alliaria petiolata (garlic mustard)			Lamium album (yellow archangel)			Viola canina (heath dog-violet)		
Allium ursinum (ramsons)			Lathyrus nissolia (grass vetchling)			Viola reichenbachiana (pale dog-violet)		
Anemone nemorosa (wood anemone)			Lathyrus pratensis (meadow vetchling)			Viola riviniana (common dog violet)		
Angelica sylvestris (wild angelica)			Leontodon autumnalis (autumn hawkbit)			Wahlenbergia hederacea (ivy-lvd bl-flower)		
Blackstonia perfoliata (yellow-wort)			Leontodon hispidus (rough hawkbit)			Allium vineale	✓	o/la
Calluna vulgaris (ling heather)			Leontodon saxatilis (lesser hawkbit)			Bromus sterilis	✓	o/la
Caltha palustris (marsh marigold)			Leucanthemum vulgare (oxeye daisy)			Elymus pycnanthus	✓	o/la
Campanula rotundiflora (harebell)			Linum catharticum (fairy flax)			Lathyrus sylvestris	✓	o/la
Campanula trachelium (net-lvd bellflower)			Listera ovata (tway-blade orchid)			Chamerion angustifolium	✓	f
Cardamine pratensis (cuckoo flower)			Lotus corniculatus (birds-foot trefoil)	✓	a	Crataegus monogyna	✓	f
Carex caryophylla (spring sedge)			Lotus uliginosus (greater birds-foot trefoil)			Clematis	✓	o/la
Carex disticha (brown sedge)			Luzula campestris (field wood rush)			Phleum bertolonii	✓	f
Carex divulsa (grey sedge)			Luzula multiflora (heath wood-rush)			Ulmus procera	✓	o/la
Carex echinata (star sedge)			Lychnis flos-cuculi (ragged robin)			Sedum anglicum	✓	r
Carex flacca (glaucous sedge)			Melampyrum pratense (cow-wheat)			Buddleja davidii	✓	o
Carex nigra (common sedge)			Mentha aquatica (water mint)			Sambucus nigra	✓	f
Carex ovalis (oval sedge)			Mercurialis perennis (dog's-mercury)					
Carex panicea (carnation sedge)			Myosotis arvensis (field forget-me-not)					
Carex pendula (pendulous sedge)			Narcissus pseudonarcissus (wild daffodill)					
Carex remota (distant sedge)			Oenanthe crocata (hmlck water-dropwort)					
Carex riparia (greater pond-sedge)			Ononis repens (common restharrow)	✓	o			
Carex rostrata (bottle sedge)			Ophrys apifera (bee orchid)			Fauna recorded during survey:		
Carex spicata (spiked sedge)			Orchis mascula (early purple orchid)					
Carex sylvatica (wood sedge)			Orchis morio (green-winged orchid)					
Centaurea nigra (common knapweed)	✓	f	Pilosella officinarum (mse-ear hawkweed)	✓	o			
Centaurea scabiosa (greater knapweed)			Pimpinella saxifraga (burnet saxifrage)					
Centaurium erythraea (cmnn centuary)			Plantago lanceolata (ribwort plantain)	✓	f			
Cerastium holosteoides (cmn. mouse-ear)			Polygala serpyllifolia (heath milkwort)					
Chrysosplenium oppositifolium (op.l.gsxfg)			Polygala vulgaris (common milkwort)					
Cirsium arvense (creeping thistle)	✓	o	Potentilla anserina (silverweed)					
Cirsium dissectum (meadow thistle)			Potentilla erecta (tormentil)					
Cirsium palustre (marsh thistle)			Potentilla reptans (creeping cinquefoil)					
Cirsium vulgare (spear thistle)			Potentilla sterilis (baren strawberry)					